

# Customer Information Sheet

IF IN DOUBT - ASK

©

NOT TO SCALE

THIRD ANGLE PROJECTION

ALL DIMENSIONS IN mm

ORDER CODE:

**F30-201XXX45R**

No. OF CONTACTS: \_\_\_\_\_  
060, 080

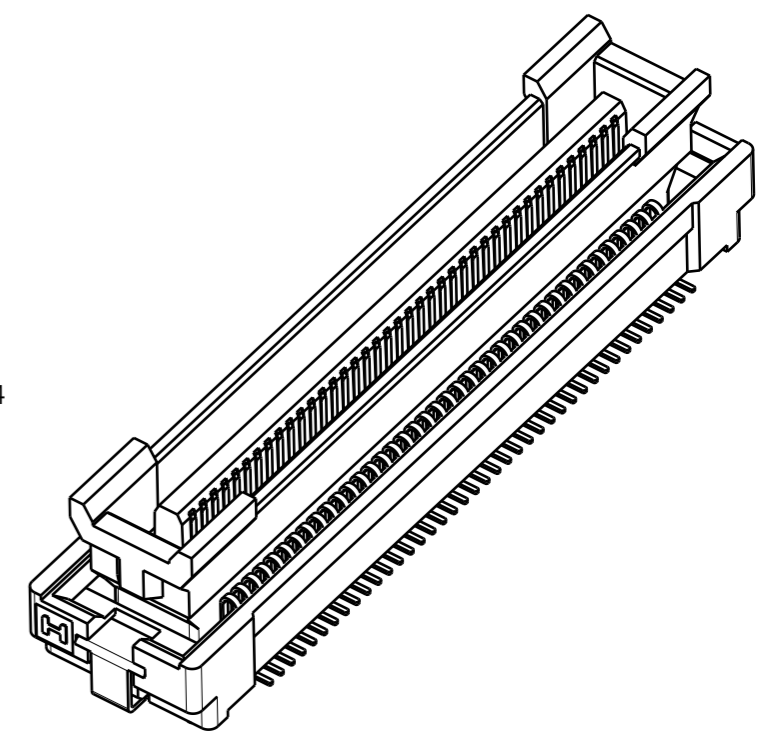
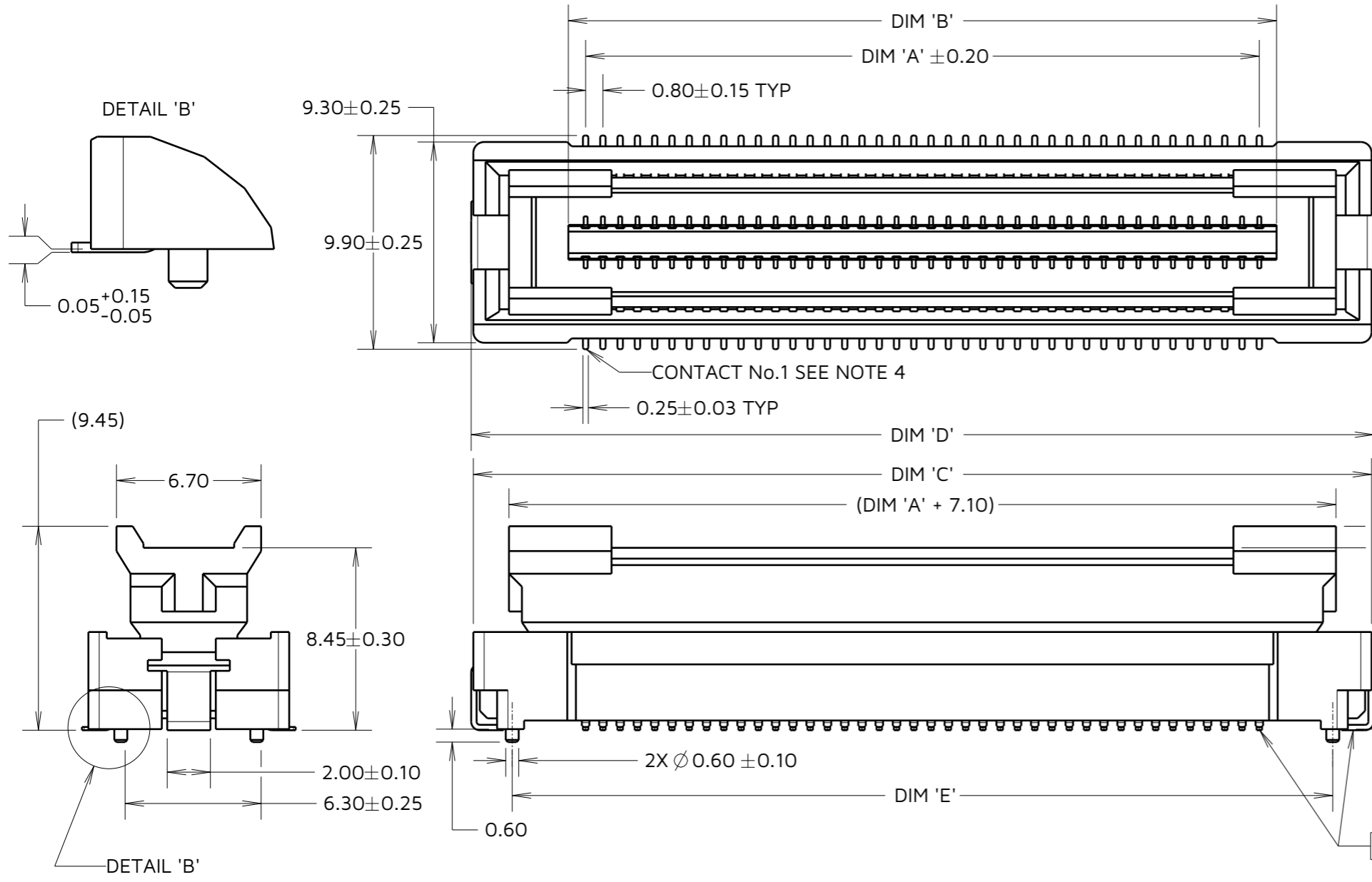
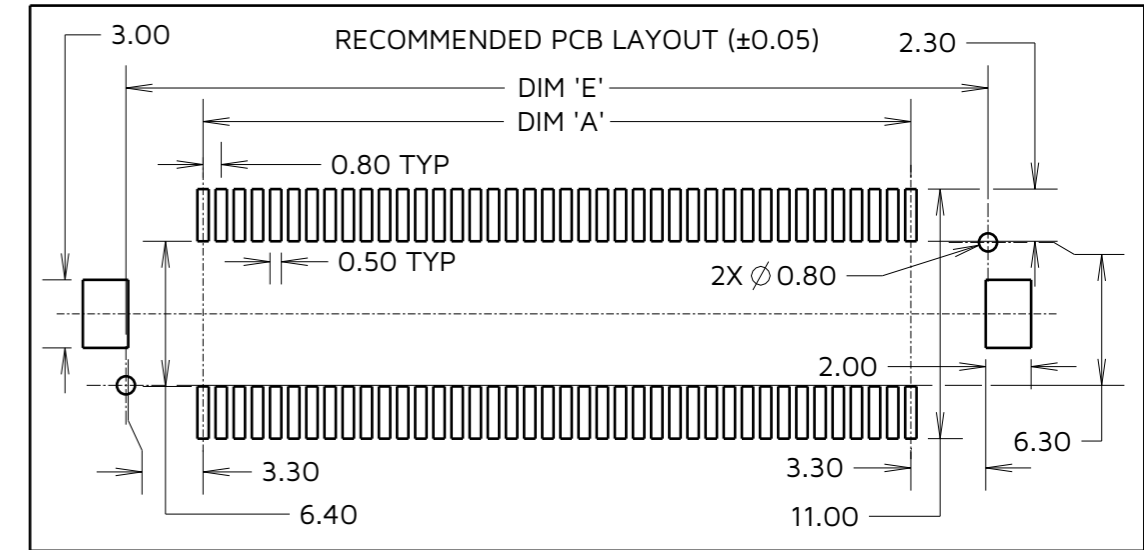

TABLE 1: DIMENSIONS

No. OF CONTACTS	DIM 'A'	DIM 'B'	DIM 'C'	DIM 'D'	DIM 'E'
60	23.20	24.8	33.6	33.8	30.0
80	31.20	32.8	41.6	41.8	38.0

TOLERANCES	
X. = ±0.30mm	X.° = ±5.0°
.X = ±0.25mm	.X° = ±3.0°
.XX = ±0.15mm	.XX° = ±2.0°
.XXX = ±0.10mm	.XXX° = ±1.0°

AB	2	24.02.24	33735
NAME	ISS.	DATE	CN/CO
APPROVED:		F.CHRISPINE	
CHECKED:		A.YEOMANS	
DRAWN:		A.BOXALL	
ASSEMBLY DRG:			

- NOTES:
- SEE COMPONENT SPECIFICATION C057XX (LATEST ISSUE) FOR COMPLETE CONNECTOR SPECIFICATIONS.
  - PART NUMBER SHOWN IS F30-20108045R, SEE ORDER CODE FOR OTHER POSSIBLE VARIANTS.
  - SEE SHEET 4 FOR TAPE & REEL DETAILS.
  - HARWIN LOGO SHOWN IN THIS ORIENTATION FOR REFERENCE ONLY. LOGO IS UNRELATED TO CONTACT No.1, AS CONTACT No.1 WILL ALWAYS BE THIS POSITION.

**HARWIN**

www.harwin.com

TOLERANCES  
X. = ±1mm  
X.X = ±0.50mm  
X.XX = ±0.20mm  
X.XXX = ±0.01mm  
ANGLES = ±5°  
UNLESS STATED

THIS DRAWING AND ANY INFORMATION OR DESCRIPTIVE MATTER SET OUT HEREON ARE CONFIDENTIAL AND COPYRIGHT PROPERTY OF THE HARWIN GROUP AND MUST NOT BE DISCLOSED, LOANED, COPIED OR USED FOR MANUFACTURING, TENDERING OR FOR ANY OTHER PURPOSE WITHOUT THEIR WRITTEN PERMISSION.

MATERIAL:  
SEE NOTE 1

TITLE: **0.8mm PITCH MALE FLECTO CONNECTOR (8.45mm HEIGHT)**

DRAWING NUMBER: **F30-201XXX45R**

# Customer Information Sheet

IF IN DOUBT - ASK

©

NOT TO SCALE

THIRD ANGLE PROJECTION

ALL DIMENSIONS IN mm

ORDER CODE:

**F30-201XXX45R**

No. OF CONTACTS:  
060, 080

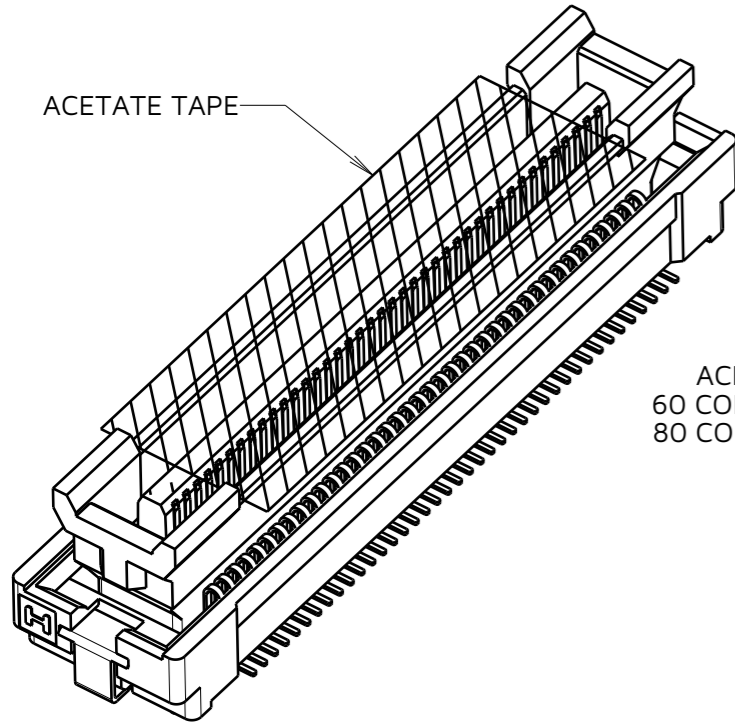

ACETATE TAPE

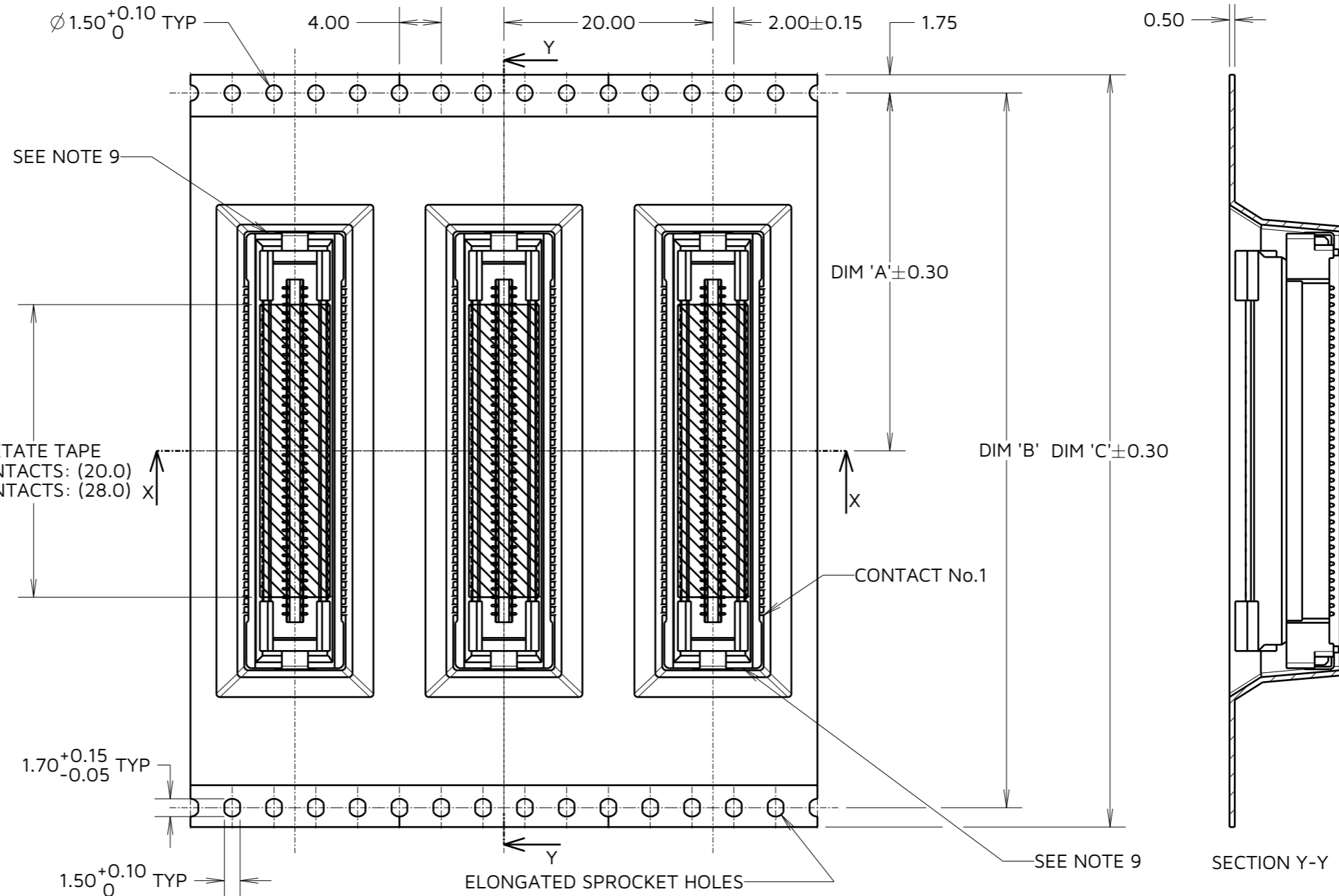

ACETATE TAPE  
60 CONTACTS: (20.0)  
80 CONTACTS: (28.0)

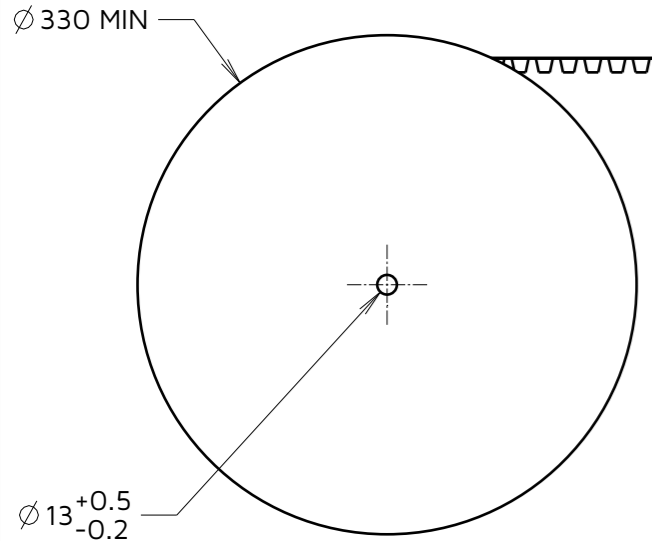

REEL DIRECTION



ELONGATED SPROCKET HOLES

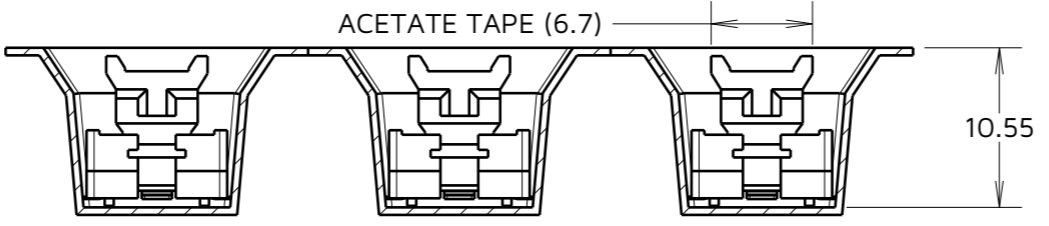

SECTION X-X

No. OF CONTACTS	DIM 'A'	DIM 'B'	DIM 'C'
60	26.20	52.40	56.00
80	34.20	68.40	72.00

AB	2	24.02.24	33735
NAME	ISS.	DATE	CN/CO
APPROVED:		F.CHRISPINE	
CHECKED:		A.YEOMANS	
DRAWN:		A.BOXALL	
ASSEMBLY DRG:			

- NOTES:
- PRODUCT TAPE AND REELED IN ACCORDANCE WITH EIA-481 STANDARD.
  - CARRIER TAPE MATERIAL: BLACK POLYSTYRENE.
  - COMPONENTS PER REEL: 250PCS
  - TAPE POCKETS MAY DIFFER VISUALLY FROM DRAWING.
  - POSITION OF HARWIN LOGO IS NOT CRITICAL AND MAY BE IN EITHER MARKED POSITION. LOGO DOES NOT AFFECT CONTACT No.1

**HARWIN**

www.harwin.com

TOLERANCES  
X. =  $\pm 1$ mm  
X.X =  $\pm 0.50$ mm  
X.XX =  $\pm 0.20$ mm  
X.XXX =  $\pm 0.01$ mm  
ANGLES =  $\pm 5^\circ$   
UNLESS STATED

THIS DRAWING AND ANY INFORMATION OR DESCRIPTIVE MATTER SET OUT HEREON ARE CONFIDENTIAL AND COPYRIGHT PROPERTY OF THE HARWIN GROUP AND MUST NOT BE DISCLOSED, LOANED, COPIED OR USED FOR MANUFACTURING, TENDERING OR FOR ANY OTHER PURPOSE WITHOUT THEIR WRITTEN PERMISSION.

MATERIAL:  
SEE NOTE 6

TITLE: **0.8mm PITCH MALE FLECTO CONNECTOR (8.45mm HEIGHT)**

DRAWING NUMBER:  
**F30-201XXX45R**