

Customer Information Sheet

DRAWING No.: M50-312XX45R

IF IN DOUBT - ASK

©

NOT TO SCALE

THIRD ANGLE PROJECTION

ALL DIMENSIONS IN mm

TAPE DETAILS
04, 05, 06, 08 & 10
CONTACTS PER
ROW

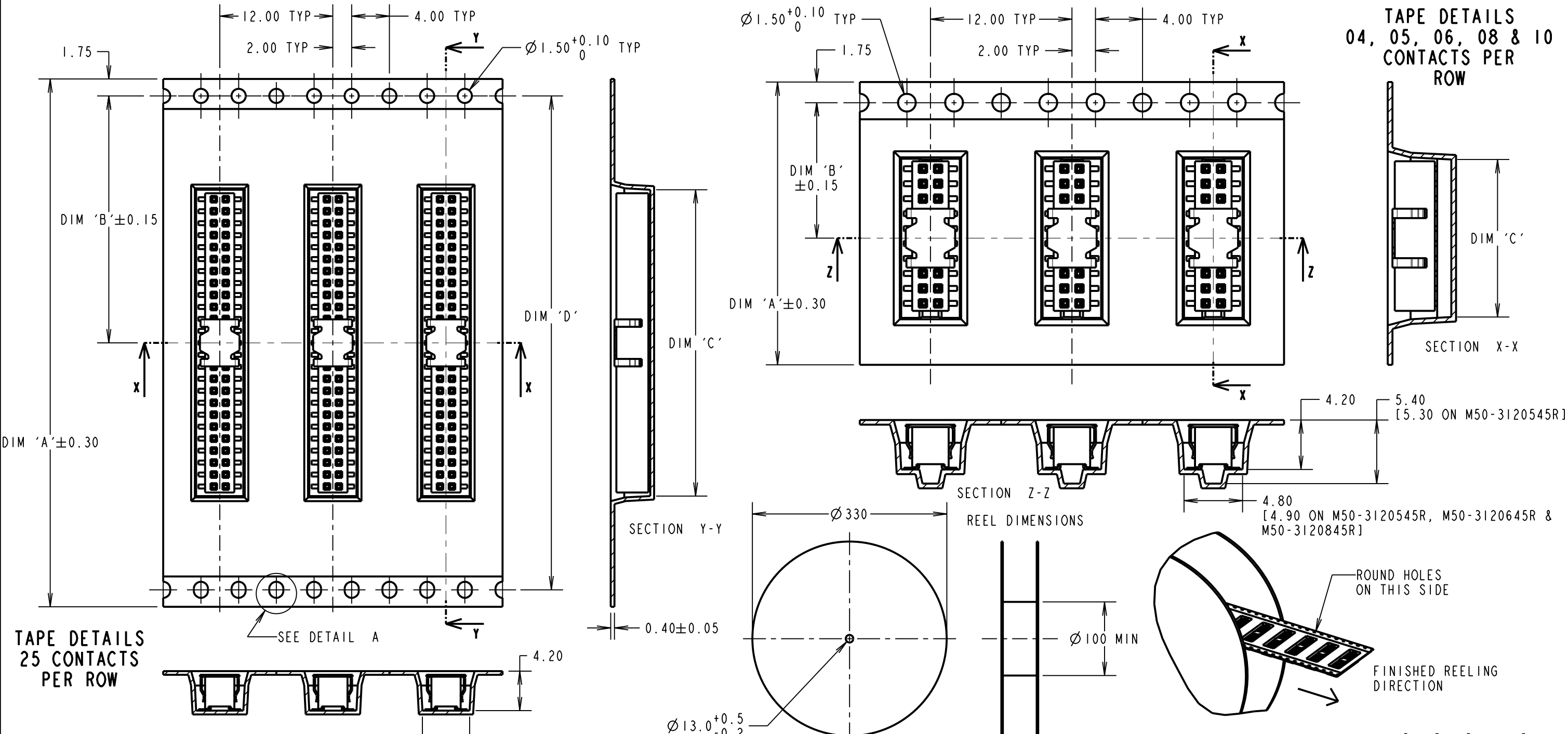

TAPE DETAILS
25 CONTACTS
PER ROW

ORDER CODE:
M50-312XX45R

No. OF CONTACTS PER ROW: _____
04, 05, 06, 08, 10, 25

FINISH: _____
GOLD FLASH OVER NICKEL

OBSOLETE
All other size/finish
combinations not
listed

Active products:
M50-3120445R
M50-3120545R
M50-3120645R
M50-3120845R
M50-3121045R

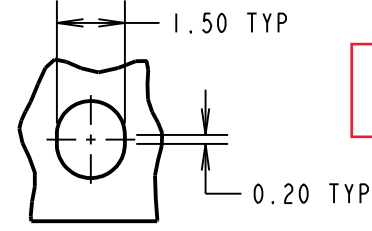

DETAIL A
SCALE 6

REELED PART No.	DIM 'A'	DIM 'B'	DIM 'C'	DIM 'D'
M50-3120445R	16.00±0.30	7.50	5.80±0.15	
M50-3120545R	24.00±0.30	11.50	7.50	
M50-3120645R			8.45	
M50-3120845R			10.90	
M50-3121045R			16.70	
M50-3122545R	56.00±0.30	26.2±0.15	32.50±0.15	52.40

- NOTES:
1. TAPE & REELING IS IN ACCORDANCE WITH EIA-481 (ELECTRONIC INDUSTRIES ASSOCIATION).
 2. CUMULATIVE TOLERANCE OVER 10 PITCHES = ±0.20mm.
 3. QUANTITY PER Ø330mm REEL = 1000 PIECES.
 4. FOR CONNECTOR DETAILS, SEE SHEET 4.
 5. M50-3120545R AND M50-3120845R HAVE VISUAL DIFFERENCES IN TAPE POCKET TO THOSE DETAILED ON THIS DRAWING.

HARWIN

www.harwin.com
technical@harwin.com

THIS DRAWING AND ANY INFORMATION OR DESCRIPTIVE MATTER SET OUT HEREON ARE CONFIDENTIAL AND COPYRIGHT PROPERTY OF THE HARWIN GROUP AND MUST NOT BE DISCLOSED, LOANED, COPIED OR USED FOR MANUFACTURING, TENDERING OR FOR ANY OTHER PURPOSE WITHOUT THEIR WRITTEN PERMISSION.

TOLERANCES
X. = ±1mm
X.X = ±0.50mm
X.XX = ±0.20mm
X.XXX = ±0.01mm
ANGLES = ±5°
UNLESS STATED

MATERIAL:
SEE ABOVE

FINISH: SEE ABOVE

S/AREA: mm²

TITLE: 1.27mm PITCH
VERTICAL SMT SOCKET ASSY
(T&R WITH P/PLACE CAP)

DRAWING NUMBER: M50-312XX45R

SHT 3 OF 4

MGP	11	23.11.21	31219
NAME	ISS.	DATE	CN/CO
APPROVED: MGP			
CHECKED: RTP			
DRAWN: JM BROOKES			
CUSTOMER REF.:			
ASSEMBLY DRG:			

Customer Information Sheet

DRAWING No.: M50-312XX45R

IF IN DOUBT - ASK

©

NOT TO SCALE

THIRD ANGLE PROJECTION

ALL DIMENSIONS IN mm

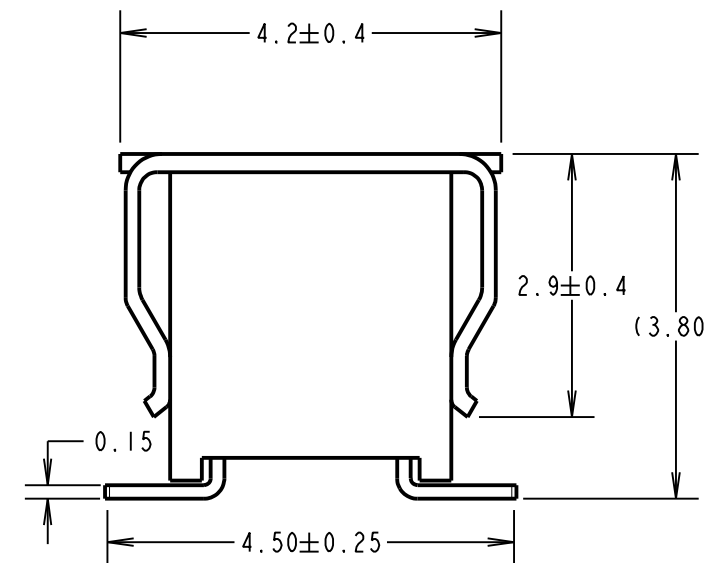
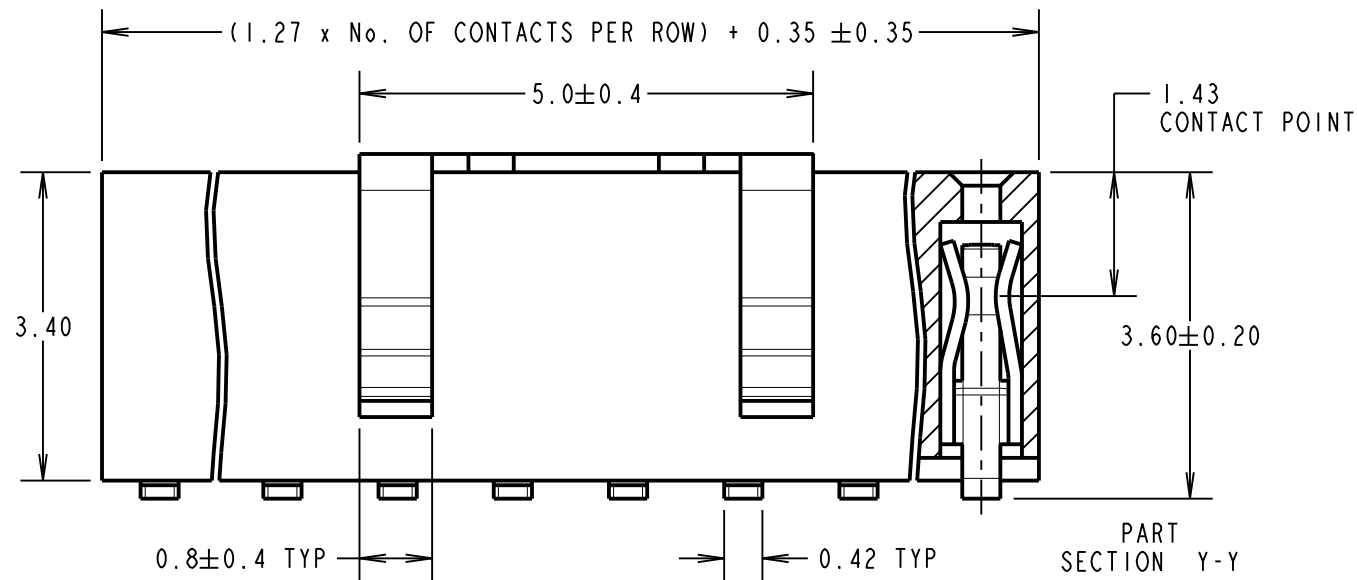
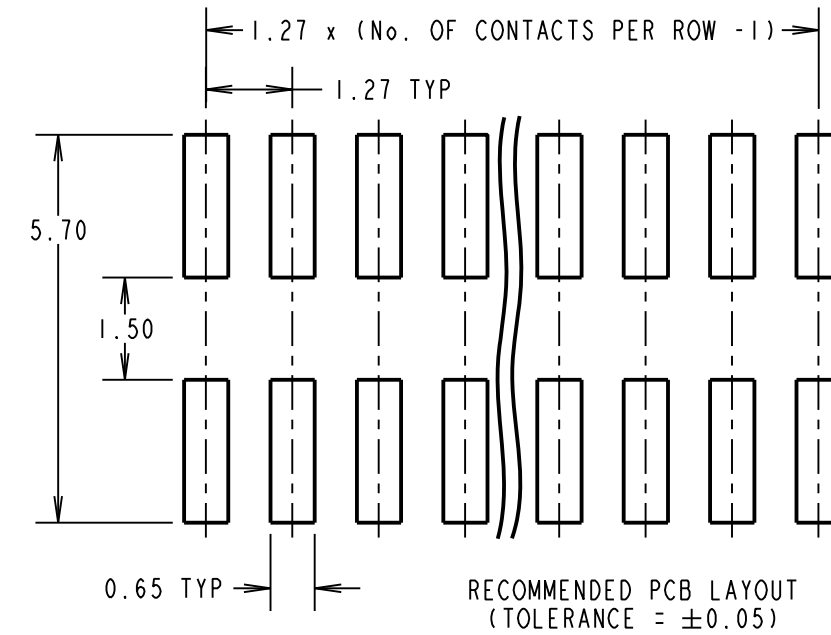
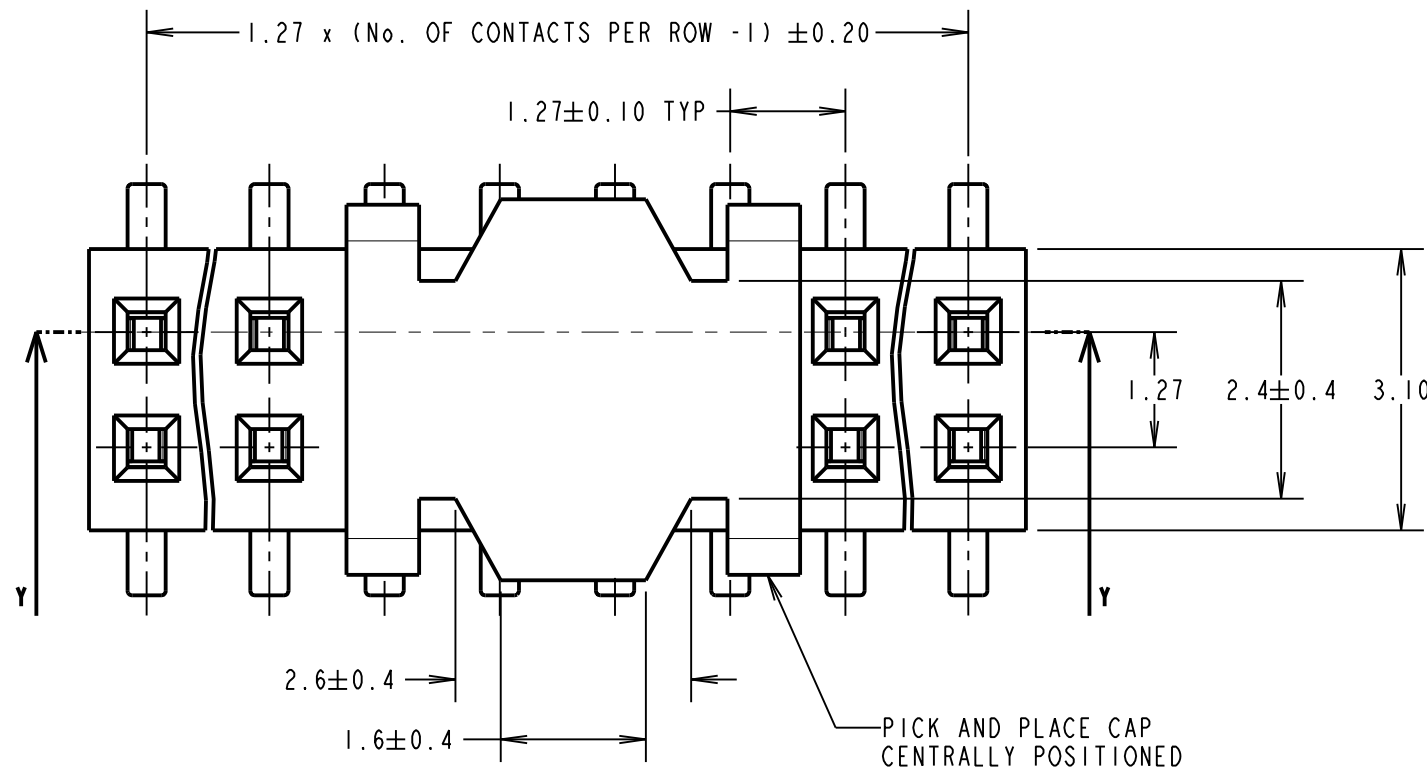

SPECIFICATIONS:
MATERIAL:
 Moulding = LCP, UL94V-0, BLACK
 CONTACT = PHOSPHOR BRONZE
FINISH:
 CONTACT = GOLD FLASH OVER NICKEL
ELECTRICAL:
 CURRENT RATING = 1A
 VOLTAGE PROOF = 300V AC, 500V DC FOR ONE MINUTE
 CONTACT RESISTANCE = $30\text{m}\Omega$ MAX
 INSULATION RESISTANCE = $1000\text{M}\Omega$ MIN
MECHANICAL:
 DURABILITY = 100 CYCLES MIN
 INSERTION FORCE = 2N MAX PER CONTACT
 WITHDRAWAL FORCE = 0.15N MIN PER CONTACT
ENVIRONMENTAL:
 OPERATING TEMPERATURE = -40°C TO $+105^\circ\text{C}$
PACKING:
 TUBE
 FOR COMPLETE SPECIFICATION, SEE COMPONENT SPECIFICATION C029XX (LATEST ISSUE)

ORDER CODE:

M50-312XX45R

No. OF CONTACTS PER ROW: _____
 04, 05, 06, 08, 10, 25

FINISH: _____
 GOLD FLASH OVER NICKEL

NOTES:

1. FOR TAPE & REEL DETAILS, SEE SHEET 3.
2. FOR DETAILS OF STANDARD COMPONENT, SEE DRAWING M50-312XX45.
3. ALL TOLERANCES ARE ± 0.15 , UNLESS OTHERWISE STATED.

HARWIN

www.harwin.com
 technical@harwin.com

THIS DRAWING AND ANY INFORMATION OR DESCRIPTIVE MATTER SET OUT HEREON ARE CONFIDENTIAL AND COPYRIGHT PROPERTY OF THE HARWIN GROUP AND MUST NOT BE DISCLOSED, LOANED, COPIED OR USED FOR MANUFACTURING, TENDERING OR FOR ANY OTHER PURPOSE WITHOUT THEIR WRITTEN PERMISSION.

TOLERANCES
 X = $\pm 1\text{mm}$
 X.X = $\pm 0.50\text{mm}$
 X.XX = $\pm 0.20\text{mm}$
 X.XXX = $\pm 0.01\text{mm}$
 ANGLES = $\pm 5^\circ$
 UNLESS STATED

MATERIAL:
 SEE ABOVE
FINISH:
 SEE ABOVE
S/AREA:
 mm²

TITLE:
 1.27mm PITCH
 VERTICAL SMT SOCKET ASSY
 (T&R WITH P/PLACE CAP)

DRAWING NUMBER:
M50-312XX45R

SHT
 4 OF 4

MGP	11	23.11.21	31219
NAME	ISS.	DATE	CN/CO
APPROVED: MGP			
CHECKED: RTP			
DRAWN: JM BROOKES			
CUSTOMER REF.:			
ASSEMBLY DRG:			